

COUPE A-A

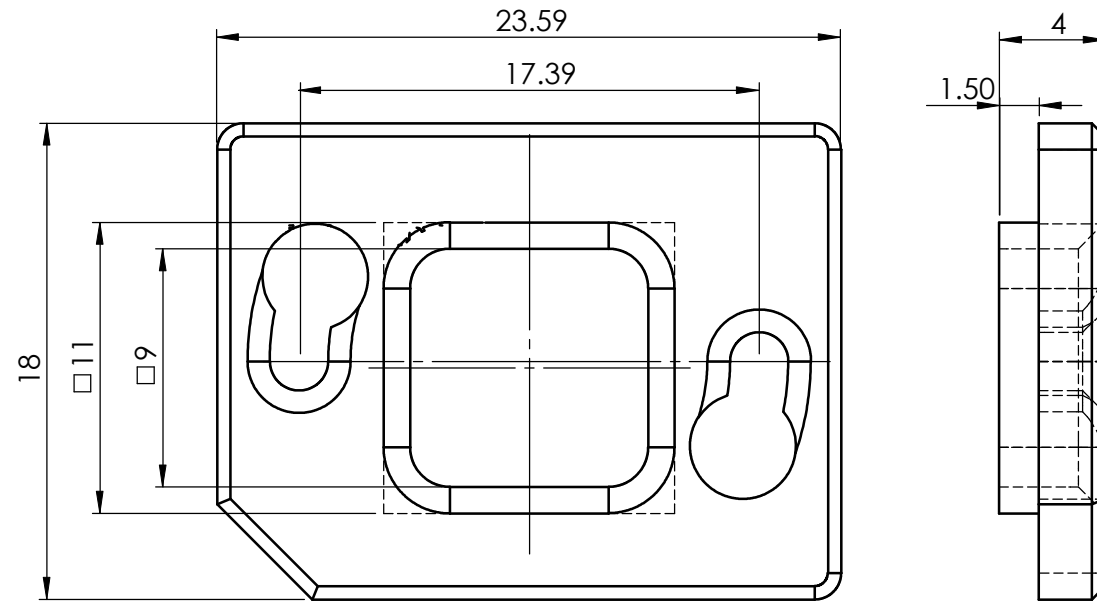

RETENTION FRAME

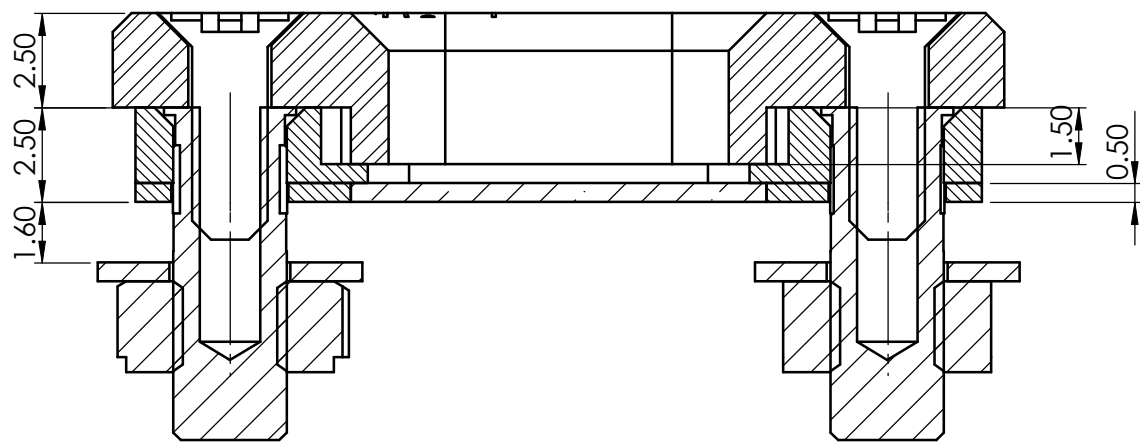
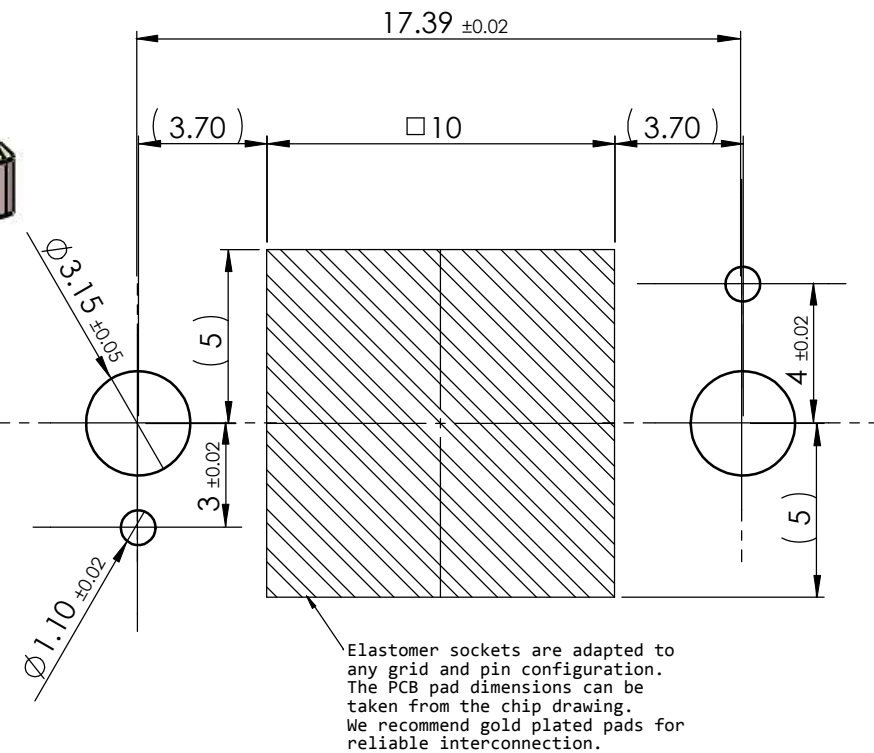
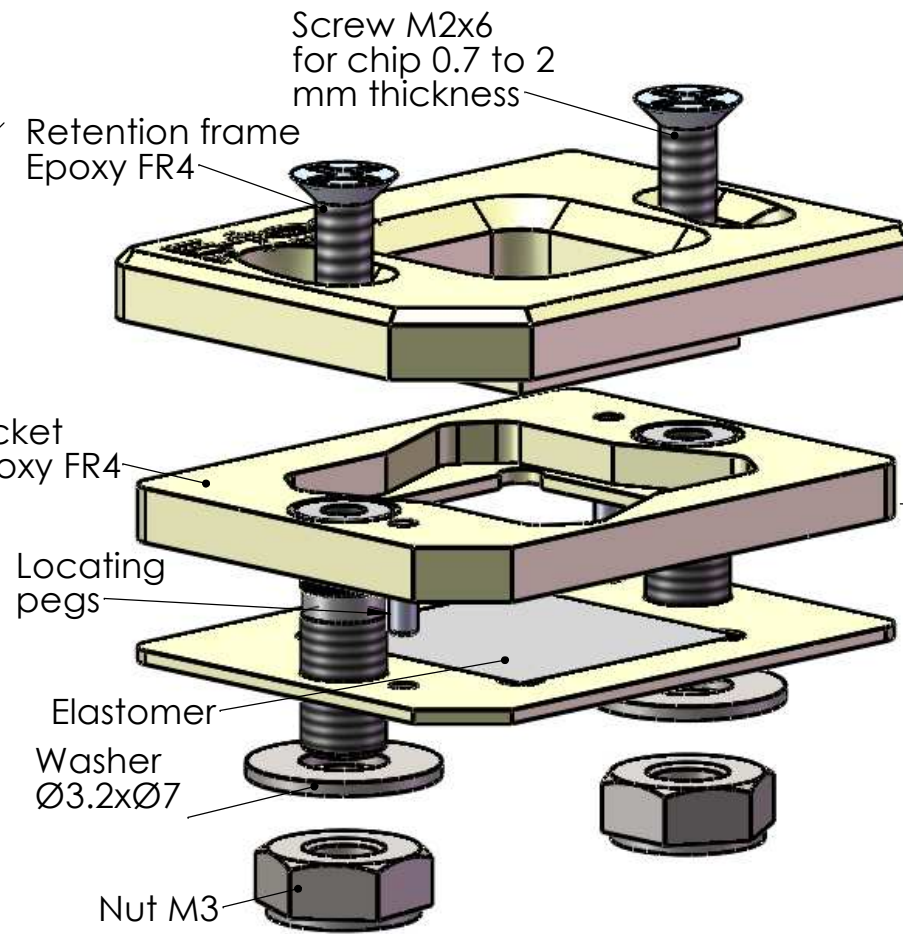
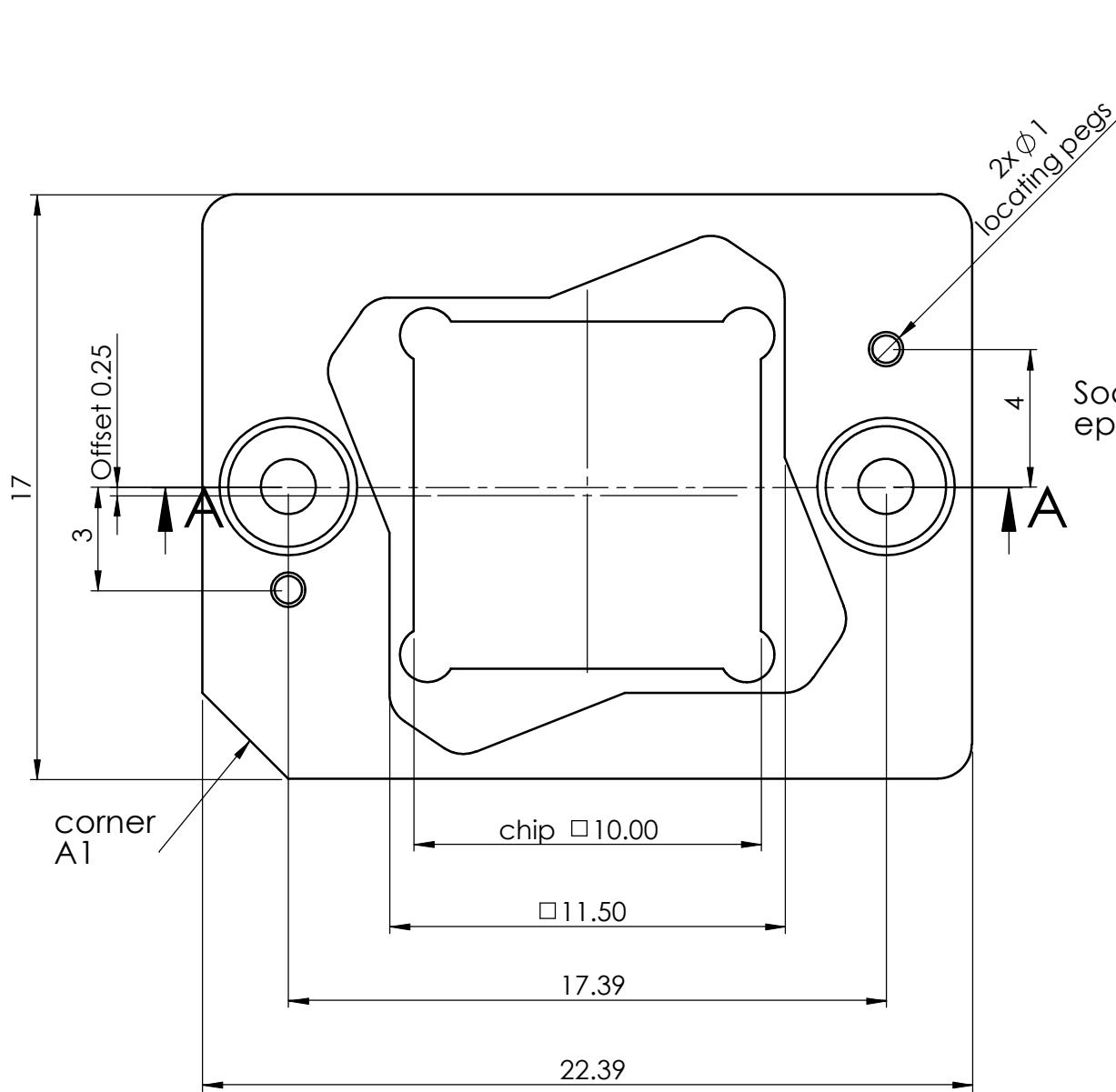

PCB LAYOUT

IMPORTANT NOTE
PCB layout is symmetrical as drawn and does not emulate the socket dimensions

CAUTION SOCKET DIMENSIONS ONLY DO NOT USE FOR PCB LAYOUT

<p>A3H Scale 5:1</p> <p>UNLESS OTHERWISE SPECIFIED: DIMENSIONS ARE IN MILLIMETERS GENERAL TOLERANCES ISO 2768m</p> <p>patented</p> <p>The information contained in this drawing is proprietary and shall not be reproduced or disclosed in whole or in part or used for any design or manufacture.</p>	<p>REV 0</p> <p>modif:</p>	<p>ELW999-9991-10MI55L</p>	<p>Remark: QFN Twist Lock socket, Chip 10x10 code MI = TwistLock + Opentop Max</p>
	<p>NAME DATE</p> <p>DRAWN 14.02.2011</p> <p>REVD - -</p> <p>CHKD - -</p> <p>APPVD 14.02.2011</p>	<p>Order code</p> <p>ELW10</p>	<p>Description</p> <p>Elastomer Socket for M-QFN 10x10mm</p>